

1

EAGLE 100



One piece top-adaptor reduces internal parts. No make up required.

Revised chamber volumes and cycle timing to optimize performance.

Simplified piston geometry for improved balance and location within the cylinder.

IDS shank reduces contact stresses and wear rates. With full chuck support.

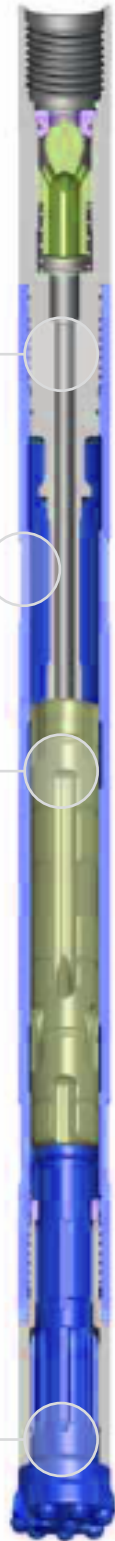

The Eagle100 is designed for small diameter drilling operations and its superior drilling performance makes it at least 50% faster than its nearest competitor.

The valveless design of the Eagle100 provides high performance at both low and high pressures. The Eagle100 has a strong robust design withstands heavy duty applications. A N.R.V. (Non-Return-Valve) is fitted into the Eagle100 to prevent flooding where ground water is present.

Suitable for operation at air pressures of 100 - 250 psi (7 - 17 bar).

Drilling diameters of 55 - 64mm (2 1/8 - 2 1/2").

Air Consumption

Air Consumption (CFM)

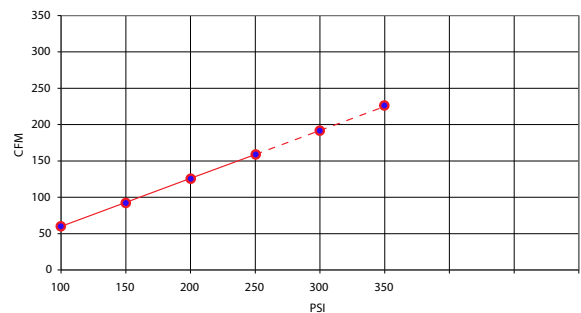

Available Shanks

IDS 1 Shank

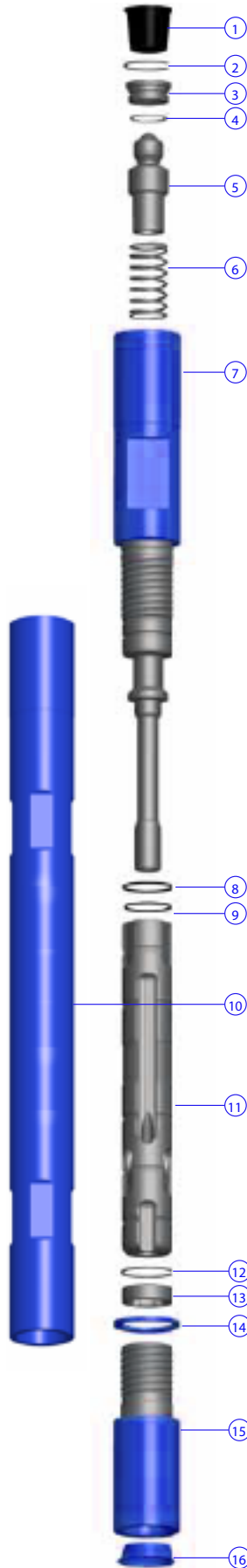

Hammer Overview

Hammer Type	Eagle 100
Part Number	E111000
Shank	IDS 1 Shank
Top Thread	40mm DIN 405 6 TPI BOX
Hammer Flat Size	38mm (1.500")
Weight	7 Kg
Outside Diameter	47mm (1.7/8")
Make Up Length	772mm (30.3/8")
Recommended Maximum Thrust	120 Kg (264 lbs)

Parts List

Hammer Type	Eagle 100	SK01	RK01
Shank	IDS 1		
Model Number	E111000	Contents	
Item	Description	Quantities	
1	Thread Protector	-	-
2	Snap Ring	2	2
3	N.R.V. Seat	-	1
4	O'Ring	2	2
5	N.R.V.	-	1
6	N.R.V. Spring	2	2
7	Top-Adaptor	-	-
8	O'Ring	2	2
9	O'Ring	2	2
10	Cylinder	-	-
11	Piston	-	-
12	Snap Ring	2	2
13	Bit Retaining Ring	-	1
14	Chuck Spacer	1	1
15	Chuck	-	1
16	Protective Cap	-	-
	Service Kit	SK01	
	Repair Kit	RK01	

Drill Bits

mm	Inch	Face		Buttons		Weight (Kg)
		Design	Type	Qty/Dia		
55	2.1/6	Flat	Domed	6 x 11mm / 2 x 9mm		1.16
64	2.1/2	Flat	Domed	6 x 11mm / 3 x 9mm		1.37

Unit 5 Spring Park, Clayburn Road, Grimethorpe,
South Yorkshire, S72 7FD

Tel: + 44 (0) 1226 713493

Email: sales@ibbotsondrillingservices.com

www.ibbotsondrillingservices.com